

Peter Kwasny GmbH, Heilbronner Str. 96
74831 Gundelsheim / Deutschland
Telefon: +496269 95-0, Fax: +496269 95-80
www.spraymax.com / www.kwasny.com / info@kwasny.de

SprayMax®
Marine 2K Epoxy anti-corrosion primer red-brown
400 ml
Art. Nr. 688010



Product

Description / Purpose

2-component epoxy anti-corrosion primer for steel and aluminium boats. This product offers excellent anti-corrosion protection and is therefore ideal for coating new parts or restoring existing components.

Properties

- Offers excellent anti-corrosion protection
- Suitable for above and below the water line
- Can be used without intermediate sanding

Material base

Two-component epoxy resins

Activator: amines

Colour

Red-brown

Gloss level

matt

VOC Value (EU)

640 g/l

Substrate

Iron (cleaned and sanded)

Steel (cleaned and sanded)

Cast iron (cleaned and sanded)

Galvanised steel (cleaned (ammonia-water solution containing a wetting agent) and sanded)

Aluminium (cleaned and sanded)

Non-ferrous metal-limited adhesion
(cleaned and sanded)
Old paint and factory paint (cleaned and sanded)

The damaged area must be dry and free of grease and dust and all rust needs to be removed.

Processing

Protection measures



Wear personal protection equipment.
(respiratory mask/gloves/goggles)
For more information, see safety data sheet.

Shake

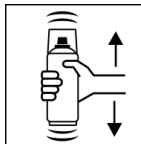

Before activating, shake can thoroughly for 2 minutes from when the mixing balls are heard.

Place red button

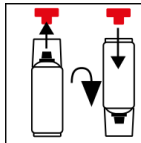

Remove the red button from the cap. Turn the can by 180° and fit the button onto the pin.

Press red button

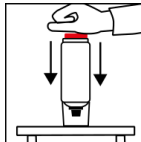

Turn the can upside down and place on a firm surface. Press the red button with the palm of your hand until it clicks into place.

Shake

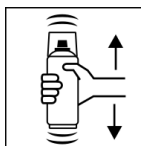

After activating, shake can again thoroughly for 2 minutes, again from when the mixing balls are heard.

Adjustable Nozzle

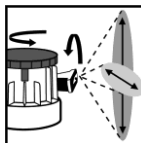

Set the variable spray nozzle to the size and pattern of the damage.

Spray to test

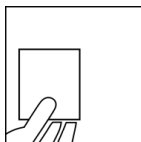

After shaking the can, test spray and check compatibility with the surface and the colour.

Spraying distance

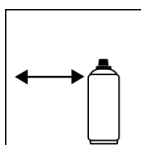

10 cm - 20 cm

Spray passes

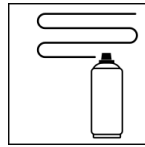

Dry film thickness 80 - 200 µm
(approx. 2 - 4 spray coats)

Flash-off time

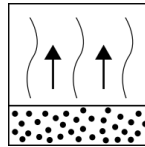

Flash time: approx. 5 - 10 min
between each spray coat.

Processing conditions



Optimum application at 18° C - 25° C and a relative
humidity from 40 - 60 %.

Coverage

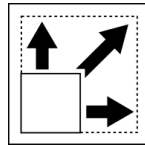

approx. 0,25 m² at 150 µm dry film thickness

Drying

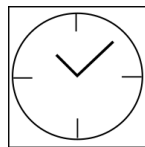

TG1 dust dry: 1.5 h
TG3 dry to touch: 3 - 5 h
Ready for sanding:
24 - 48 hours (after adequate drying)

The stated values refer to the above-mentioned
processing conditions. The level of dryness is
determined pursuant to DIN 53150.

End flash-off time

End flash time approx. 5 h (before processing)

Continue

Can be topcoated within 30 days without interme-
diate sanding (if there is no chalking or other soiling)
After 30 days the surface must be sanded. Possible
subsequent coats: Marine 2K epoxy primer filler,
epoxide filler compounds, polyurethane systems,
antifouling systems.

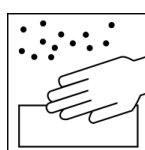

Before coating: P 80 - P 120 coarse sanding;
P 120 - P 240 final sanding
After drying: P 240 - P 400

Pot life

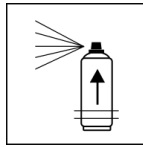

Approx. 48 h at 20° C room temperature and a relative humidity of approx. 40 - 50 %. The processing time depends on the ambient temperature. Higher temperatures reduce the pot life, lower temperatures will prolong it. Do not process below room temperature.

Finish

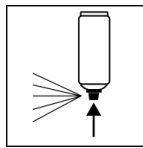

After painting, turn the can upside down and spray the valve until empty.

Additional Information

Important Information



Avoid bumps, friction and impact.

Water load should only be allowed after 5 - 7 days.

Shelf Life

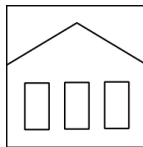

36 months (not activated)

The usage period refers to an unused can that is stored correctly at a temperature of 15 - 25° C and a relative humidity below 60%. The can must be stored and transported in an upright position in a dry place where it is protected against chemical and mechanical influences. The safety information on the can and all statutory provisions applicable for the storage site must be observed.

Disposal



The completely emptied spray cans must be disposed of in the recycling system. Cans with hardened material must be disposed of as special waste.

Note

For professional use only.

Identification, see safety data sheet.

The contents in this technical data sheet were created with great care and reflect our current state of knowledge. They provide the user with application-specific information and do not promise certain properties. The information is non-binding and we accept no liability for its integrity, accuracy and completeness. They do not relieve the user of their duty to check the suitability of our product for the intended purpose. The warnings printed on our labels must be respected. Our brands and patents are protected by copyright. All rights reserved We reserve the right to update, amend or supplement the content of the information without prior notice.